

Installation Instructions

15KP Series

All Silicon Unidirectional

Transient Voltage
Suppressor

Outline Dimensions:

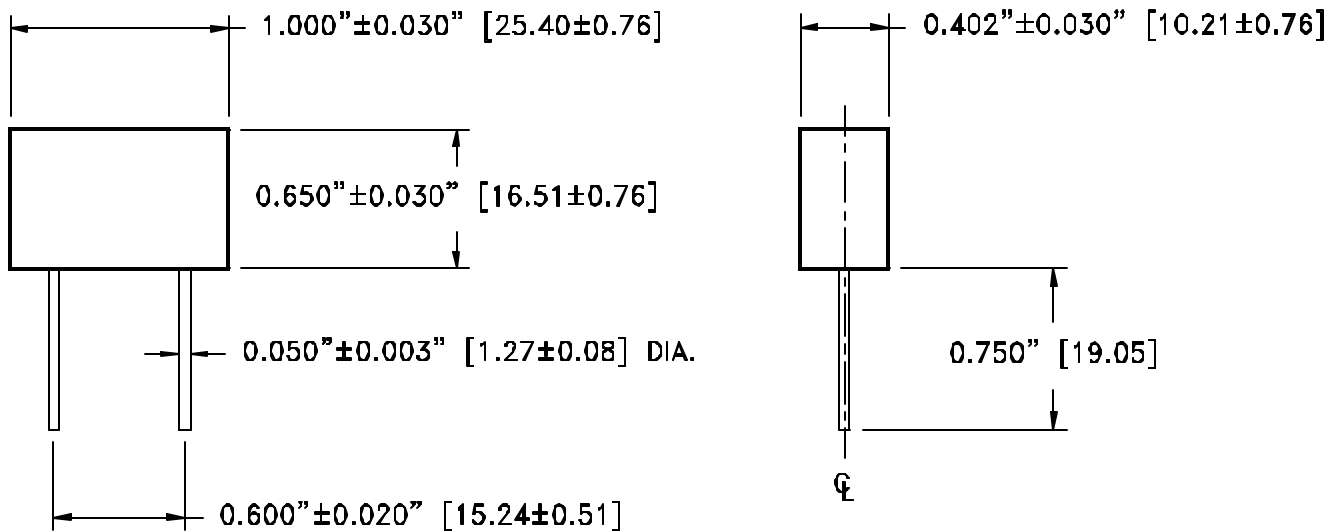

DIMENSIONS ARE IN INCHES

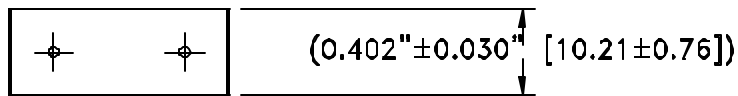

Wiring Instructions:

CAUTION: Make sure equipment power is OFF before installing suppressor.

- (A) Confirm correct operating voltage to ensure correct suppressor use.
- (B) Observe normal care relative to solid state components in soldering the 15KP to PCB.
- (C) Solder terminal marked [+] to plus side of DC power supply on PCB.
- (D) Solder terminal marked [-] to negative side of DC power supply on PCB.
- (E) Restore Power to **ON**.

Note: For long duration transients, a large PCB land surface should be provided to remove heat via the device leads.